

DESCRIPTION

Diffuser can be used for both air intake and exhaust.
 Recommended for ceiling and drop ceiling applications.
 360 degree diffusion pattern.
 Made of steel with polymeric coating.
 Will not rust.
 The baffle can be rotated to obtain the required air consumption listed in the specifications.
 Supplied with mounting collar (model VRF).



DIMENSIONS

Model	Measurements [in.]				Air pass, Sq.Ft
	Ø D	Ø D1	H	H1	
AM 100 VR	5 1/16"	3 7/8"	1 3/4"	2 1/16"	0.043
AM 125 VR	6"	5 1/16"	1 3/4"	2 1/16"	0.075
AM 150 VR	7 1/4"	5 13/16"	1 3/4"	2 1/16"	0.107
AM 200 VR	9 1/4"	7 13/16"	1 3/4"	2 1/16"	0.215

Model	Measurements [in.]				Air pass, Sq.Ft
	Ø D	Ø D1	Ø D2	Ø D3	
AM 100 VRF	3 7/8"	4 13/16"	2 15/16"	5 1/16"	0.043
AM 125 VRF	4 7/8"	6"	3 15/16"	6 1/16"	0.075
AM 150 VRF	5 7/8"	6 13/16"	5 1/16"	7 1/4"	0.107
AM 200 VRF	7 13/16"	8 7/8"	7"	9 1/4"	0.215

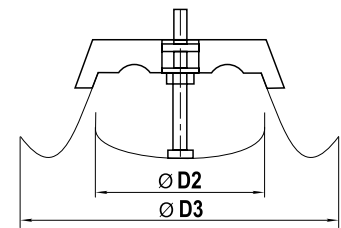
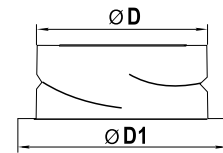
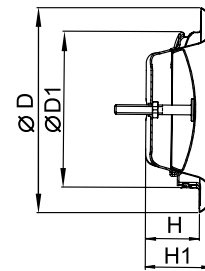

MODEL	QUANTITY	COMMENTS	PROJECT
			location:
			architect:
			engineer:
			contractor:
			submitted by: