

## A...VRF series INSTALLATION GUIDE



### APPLICATION

- For supply and exhaust ventilation, air conditioning and air heating.
- Mounting in drop ceiling, dry walls and more.

### DESIGN

- Made of high quality plastic (ABS plastic or polystyrene).
- Special aerodynamic disk valve design ensures uniform air distribution.
- Easy mounting with spacing lugs and mounting flange with a lock ring.
- The internal part has a sealing ring for more tight fit.
- Equipped with a mounting flange and a lock ring for easy connection to round 4-8 inch air ducts.
- Mounting flange is fixed to false ceiling with screws.
- Lock ring provides easy fixing of the flexible air duct on a mounting flange.

### INSTALLATION

#### TOOLS

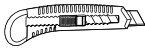

Knife

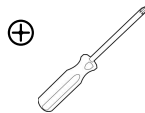

Screwdriver



Pencil



Screws 4 pc for 3/16" openings

#### A) TRACE THE HOLE

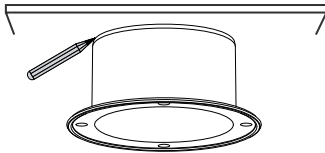

#### B) CUT THE HOLE AND INSERTING THE COLLAR

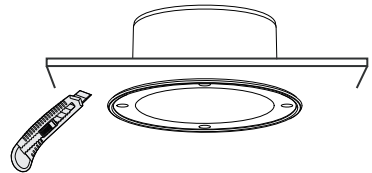

#### C) ATTACH THE COLLAR TO A DROP CEILING WITH SCREWS

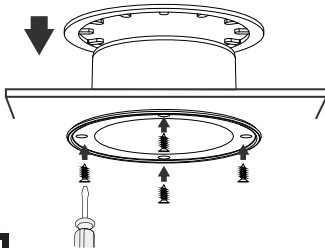

#### D) ATTACH THE AIR DIFFUSER TO THE COLLAR

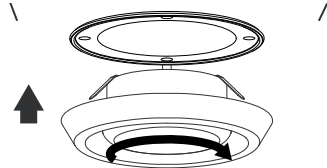

Rotate diffuser central part clockwise to reduce airflow  
or counterclockwise to enhance.

