

INSTALLATION GUIDE

BATHROOM EXHAUST KITS

TT SILEN KIT 100-1/100-1L/100-1H

- TT Silent 100 (110 CFM)

- D-Box (no light)/100L (LED light)/100H (Halogen light)



INSTALLATION

Tools required



Pencil



Drill



Screwdriver



Dowel (4 pcs.)



Screws (4 pcs.)

MOUNTING

Typical installation of the TT Silnet Kit 100-1L

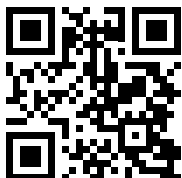
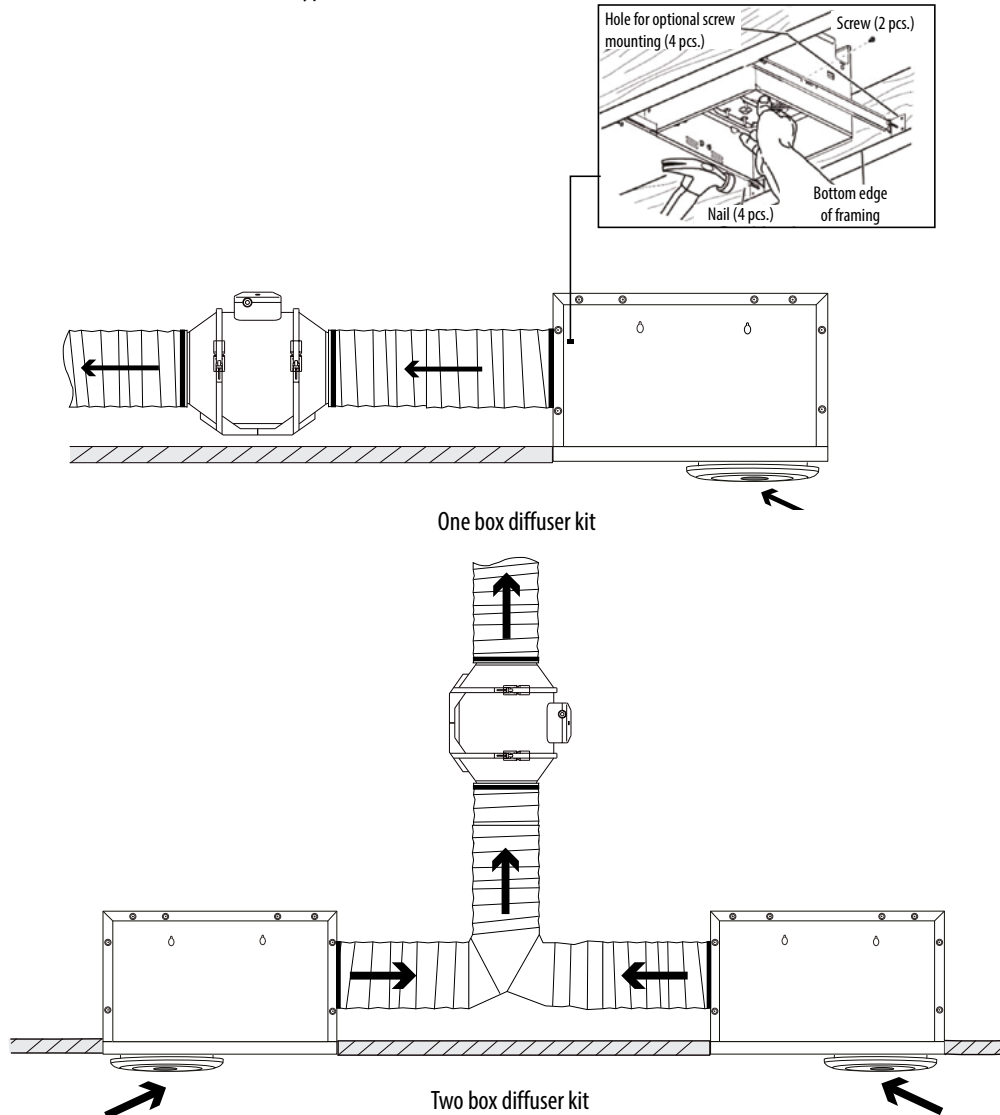

vents-us.com

Vents-US
 400 Murray Road, Cincinnati, OH 45217, USA
 Tel: 1-888-640-0925, 513-583-5786, Fax: 513-268-4597
 E-mail: support@ventsus.com

INSTALLATION GUIDE

Connection of the TT Silnet Kit 100-1L and standard wall socket

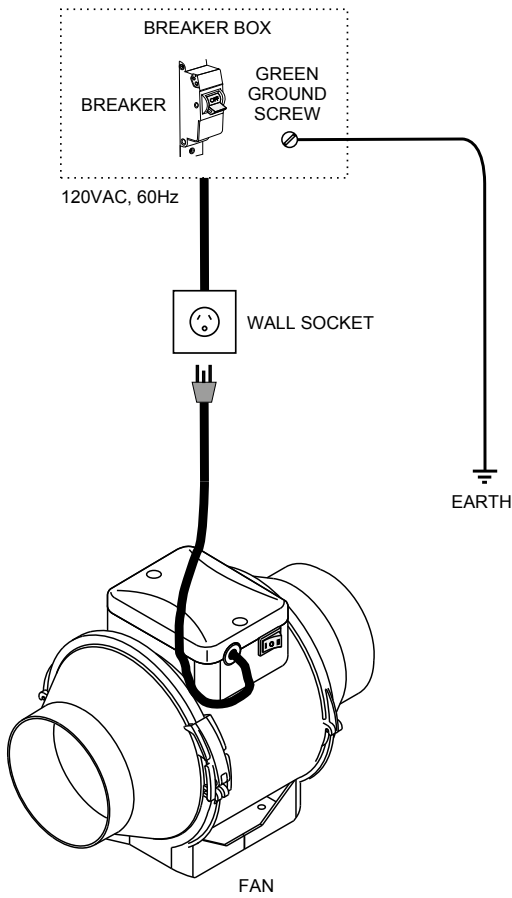

The fan must be connected using durable, insulated and heat-resistant cables and wires.

Connect the cables according to the wiring diagram.

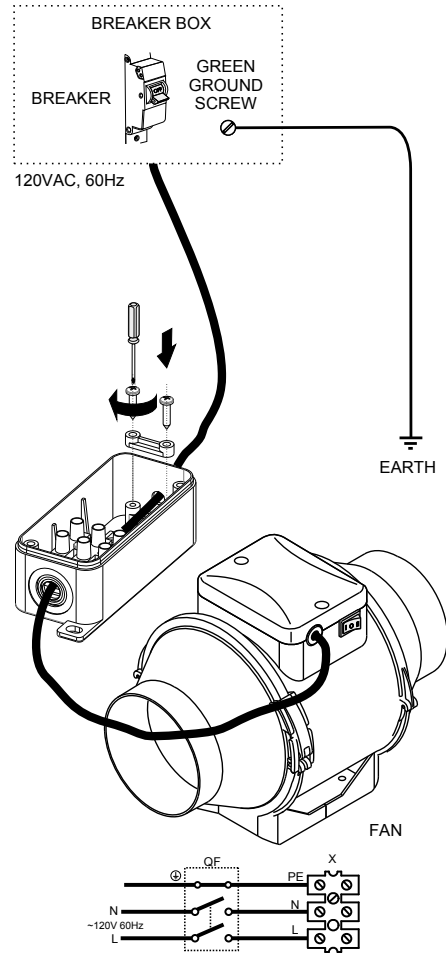

Connection of the D-Box 100 L (LED light)



Available with optional LED MR-16 trim. 6W, GU-10 lamp, 4100K, 410 lumens, with a 30,000 hour rated life.

For fan with light and night light

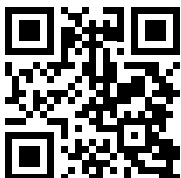
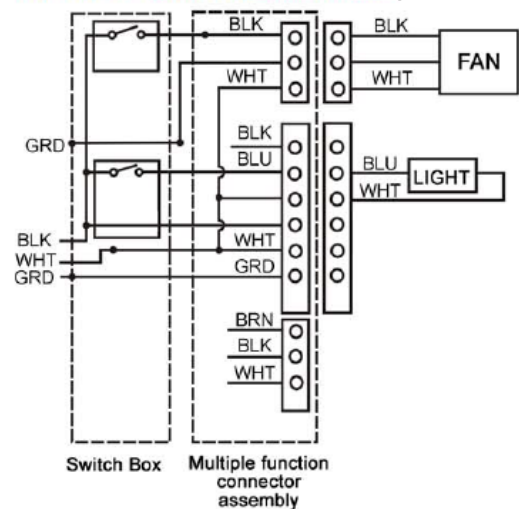

vents-us.com

Vents-US
400 Murray Road, Cincinnati, OH 45217, USA
Tel: 1-888-640-0925, 513-583-5786, Fax: 513-268-4597
E-mail: support@ventsus.com