

**MV 120 Vs**  
**MV 150 Vs**

**INSTALLATION**

TOOLS REQUIRED

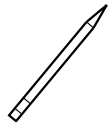

Pencil



Drill

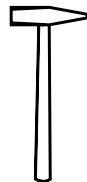

Hammer

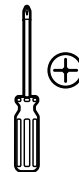

Screwdriver



Dowel 4 pcs



Screws 4 pcs

1 DISASSEMBLE THE HOOD

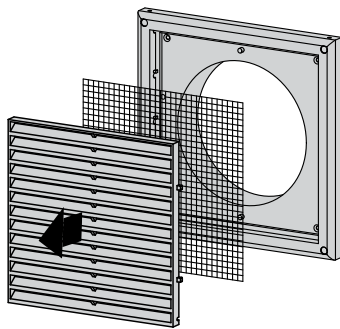

2 MARK FASTENING HOLES USING THE FRAME

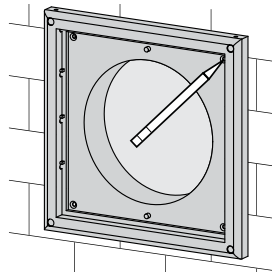

3 DRILL HOLES ON THE MOUNTING SURFACE ACCORDING TO THE MARKING

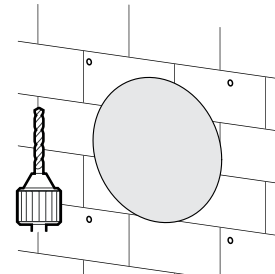

4 INSERT THE DOWELS IN THE HOLES.

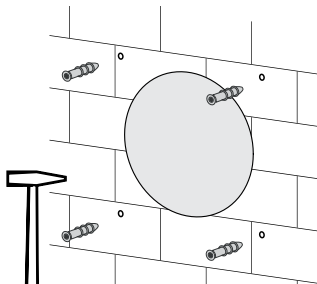

5 FIX THE FRAME ON THE MOUNTING SURFACE WITH SCREWS.

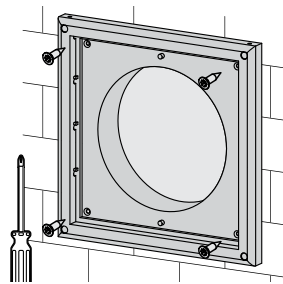

6 INSTALL THE FILTER AND FIX THE HOOD ON THE FRAME USING THE "SNAP IN PLACE" FEATURE.

