

VKPF SERIES

FOR DRYER BOOST APPLICATION



EXCELLENT AERODYNAMICS & LOW NOISE

The external rotor motor on ball bearings and the forward curved, balanced impeller is suitable for high pressure application, prevent vibration and assure quiet operation.

HOUSING

The fan's housing is made of galvanized steel. Available with two inlets.

INSTALLATION BENEFITS

Suitable for low ceilings and tight spaces.

VKPF series fans are specially designed for extract and input ventilation and are perfect air movement solution for areas with tight spaces. It provides airflow up to 267 CFM (VKPF 125/125*2). Fans is suitable for a wide range of residential and light commercial applications such as high-rise condominium, office buildings, schools, boardrooms etc. The fans offer a variety of choices of extract and input ventilation options and enables ducting from multiple sources.

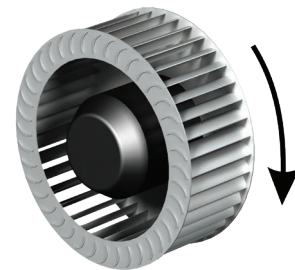

forward curved impeller - extra quiet



Installation example

DIMENSIONS

Model	Measurements [in.]					
	D"	D1"	A"	B"	L"	H"
VKPF 125/125*2	5	5	0.2932	11 1/8	14 5/8	7 1/2

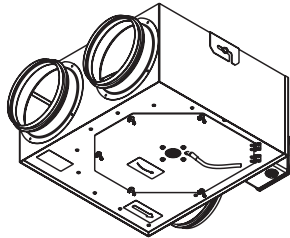

VKPF 125/125*2

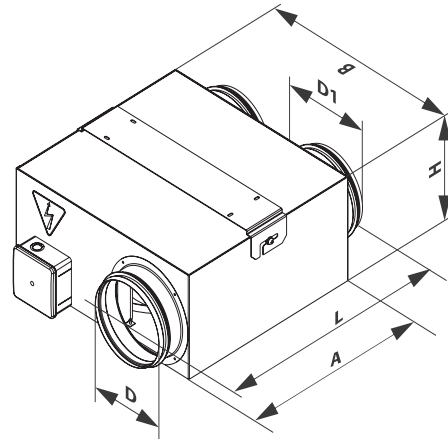

PERFORMANCE

Model	Duct dia	Max Watts*	Max Amps*	Sones	CFM vs. Static Pressure (Ps) in WG											Max. Ps	Volts / Hz
					0"	0.1"	0.2"	0.3"	0.4"	0.5"	0.6"	0.7"	0.8"	0.9"	1"		
VKPF 125/125*2	5"	80	0.68	3.5	267	256	246	234	216	195	177	152	55	0.84	120 / 60		

* Indicated at 0.2 in.W.G.

SPECIFICATION

Voltage: 120 V, 60 Hz
 Motor: Single-phase asynchronous motor
 Duct compatibility: Ø 4", 5"
 Airflow capacity: up to 267 CFM

Power consumption: 80 W
 Suitable for working airstreams up to 13-140 °F
 IPX4 protection
 Thermal overload protection